

Briton

Door Closer - 200 Series Template for Parallel Arm - Push Side Mounted

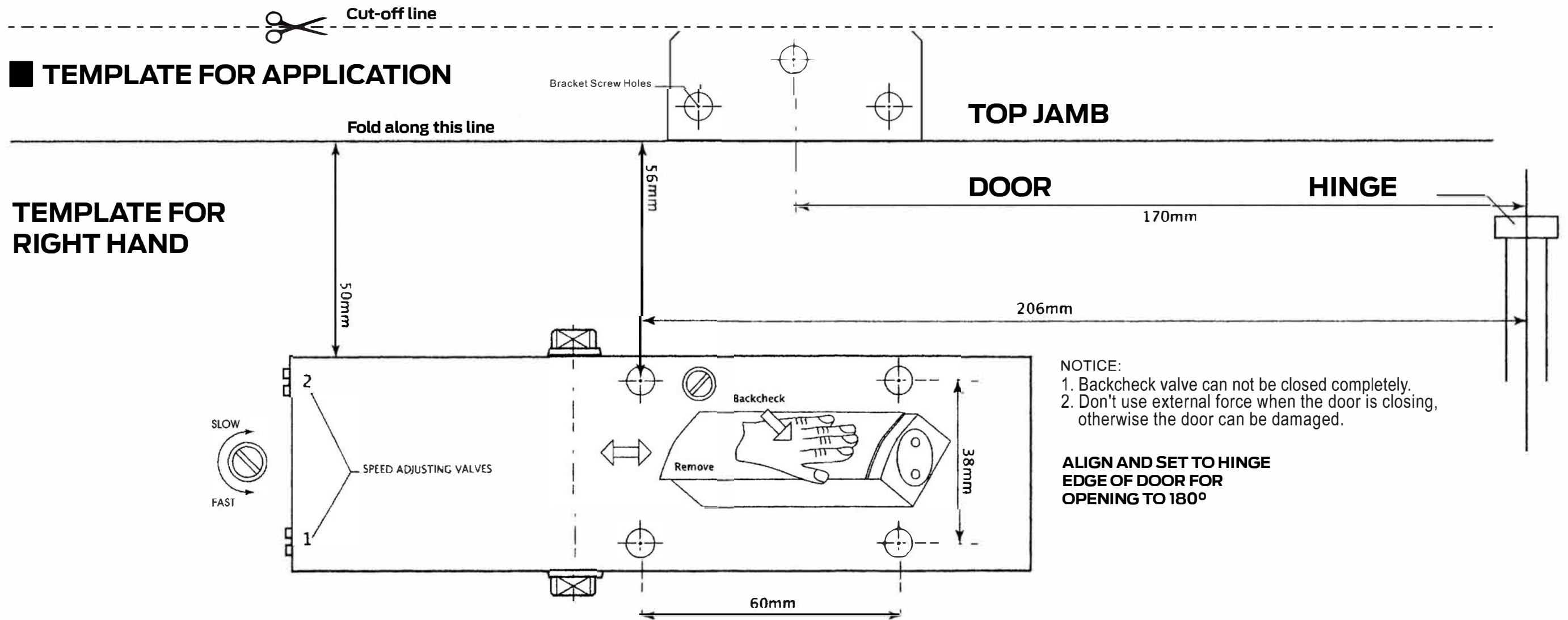
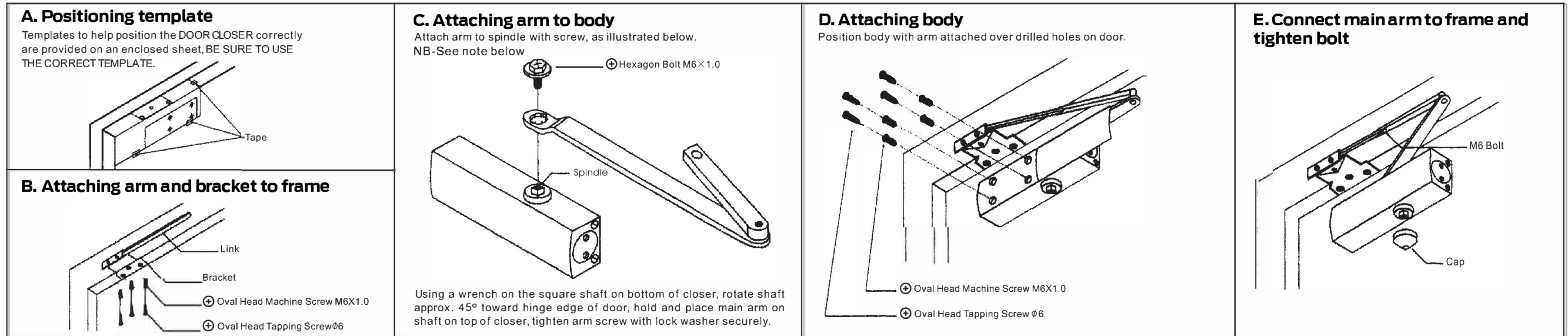

Briton

Door Closer - 200 Series Template for Parallel Arm - Push Side Mounted

<p>Installation drawing (LEFTHAND)</p>	<p>Location of door closer on the door</p> <p>Determine whether the door is left hand or right hand using the following illustrations. Remember the DOOR CLOSER is always mounted near the hinge edge of the door. This illustration shows the mounting for outward opening doors, as seen from inside the building.</p> <div style="display: flex; justify-content: space-around;"> <div style="text-align: center;"> <p>RIGHT HAND</p> </div> <div style="text-align: center;"> <p>LEFT HAND</p> </div> </div>	<p>Regulating door speed and latching speed</p> <p>Turn speed regulating valves clockwise to slow down or counter clockwise to speed up door movement.</p>
---	---	---

Cut-off line

TEMPLATE FOR APPLICATION

Fold along this line

TOP JAMB

HINGE **DOOR**

170mm

206mm

56mm

38mm

60mm

50mm

Bracket Screw Holes

TEMPLATE FOR LEFT HAND

1

2

SPEED ADJUSTING VALVES

FAST

SLOW

NOTICE:

1. Backcheck valve can not be closed completely.
2. Don't use external force when the door is closing, otherwise the door can be damaged.

ALIGN AND SET TO HINGE EDGE OF DOOR FOR OPENING TO 180°